



C600

COMMERCIAL ALUMINUM SERIES

Casement | Project-Out | Fixed



**Structurally Superior. Thermally Enhanced.
The Modern Architectural Solution for Your Next Build.**

www.QuakerCommercialWindows.com

C600

COMMERCIAL ALUMINUM SERIES

Today's Window for a New Age

The commercial building industry is changing and evolving faster than ever before. As this tempo continues to quicken, one window is not only keeping pace...it's raising the bar. Quaker's C600 Series with patented OptiCore® technology is the ultimate architectural solution.

The C600 Series is a multi-tasking marvel, able to fit within trendy and multifaceted 21st century building designs, while also merging neatly into traditional architecture -- new construction or replacement.

- Strong, AW-ratings
- Long-term durability
- Extreme energy-efficiency
- Flexibility
- Functionality and practicality
- OptiCore® Technology



Fastenal Downtown Offices
Winona, MN
Developer: Fastenal Company
Contractor: C.D. Smith Construction
Architect: The Kubala Washatko Architects

Credit: Western Archrib/westernarchrib.com



www.QuakerCommercialWindows.com

C600

COMMERCIAL ALUMINUM SERIES

OptiCore® Technology

Patented and proprietary, OptiCore® Technology is industry-altering. It boosts every element of today's commercial building drive -- structural properties, thermal efficiency, and sound attenuation. Quaker's C600 Series and OptiCore® Technology are changing the face of architectural window design.

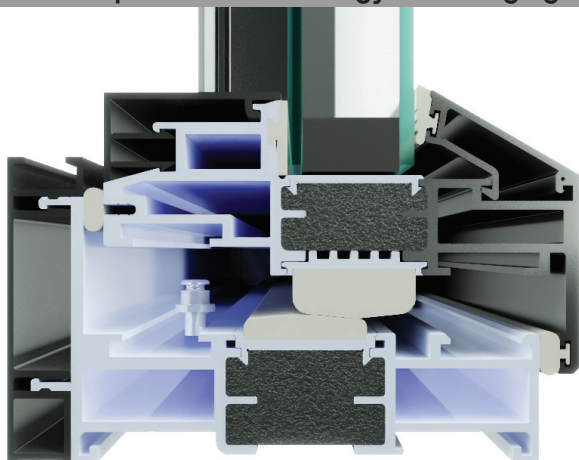

Quaker's OPTICORE® TECHNOLOGY encompasses several different patents, which involve innovations that set these products apart from other window systems in the industry.

- The next generation of thermal barrier technology is right here, right now. Quaker's C600 products utilize Azon's Azo-Core™ thermal barrier, which helps achieve superior performance compared to traditional polyamide strut or pour & debridge systems.
- Thermally-aligned framing, paired with highly-efficient dual or triple pane insulating glass, minimizes thermal conductivity, leading to U-Values never thought possible from an aluminum window.
- An expertly designed glazing pocket, which allows for up to 1 1/2" insulating glass, reduces noise intrusion and takes STC and OITC ratings to a higher level.
- Architecturally enhanced aluminum is engineered to maximize structural capacities, especially with taller and wider windows now the norm.
- Double corner key construction is utilized to provide maximum corner joinery and frame strength.

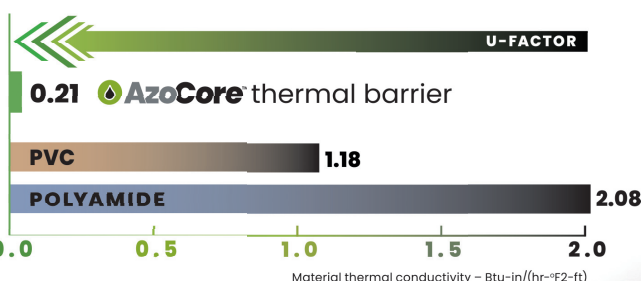

Learn more about Quaker's
OptiCore® technology



800-347-0438



C600

COMMERCIAL ALUMINUM SERIES

Selection Guide

| C600/C605 Model | Frame Depth | Structural Test Rating | Test Size | Air Infiltration | Water Resistance | U-Value Range [#] | SHGC Range [#] | STC Range ^x | OITC Range ^x |
|-----------------|-------------|------------------------|-----------|------------------|------------------|----------------------------|-------------------------|------------------------|-------------------------|
| Casement | 4 1/8" | up to AW-PG100 | 48" x 84" | <0.10 | 15.04 | 0.19-0.37 | 0.11-0.45 | 28-41 | 28-41 |
| Project-Out | 4 1/8" | AW-PG100 | 60" x 36" | <0.10 | 15.04 | 0.19-0.39 | 0.11-0.45 | 28-41 | 28-41 |
| Fixed | 4 1/8" | AW-PG100 | 60" x 99" | <0.10 | 15.04 | 0.15-0.35 | 0.13-0.57 | 30-40 | 30 |

[#]-U-Value and SHGC ranges are based on I.G. combinations incorporating some or all the following: Low-E glass, clear glass, argon gas and/or air fill, and grids

^x-STC and OITC Ranges based on multiple I.G. combinations

All ratings listed are NAFS certified. Periodic re-certification testing is required thus data shown may vary slightly



Westhaven Park IID
Chicago, IL
Developer: WHP IID, LLC
Contractor: McShane Construction
Architect: Landon Bone Baker Architects
Comm. Window Dealer: Commercial Window Installers

Credit: McShane Construction / mcshaneconstruction.com

C600

COMMERCIAL ALUMINUM SERIES

Products

Casement

- Up to AW-PG100 Rating
- Patented OptiCore® technology
- Architectural grade aluminum
- Up to 1½" I.G. w/warm-edge spacer
- With or without Integral nailing fin
- Roto and Cam-Handle hardware
- Optional OS Operator hardware
- FlexScreen® system
- Blinds/Storm Panel option
- Standard and custom sizing
- Continuous frame combination capability
- Modern/Square exterior glazing profile (C600) or Traditional/Historic Bevel exterior glazing profile (C605)
- Impact version (C670/C675)

C600 Casement
shown with roto hardware, nail fin, modern/squared frame glazing, and blinds/storm panel

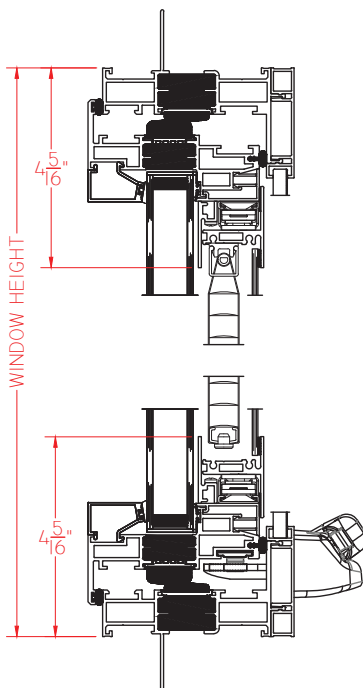

C605 Casement
shown with roto hardware, nail fin, traditional/historic beveled frame glazing and blinds/storm panel

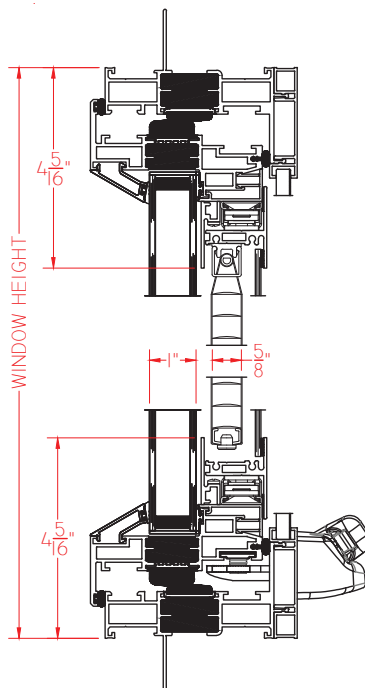

C600 Casement
shown with roto hardware, nail fin and modern/squared frame glazing

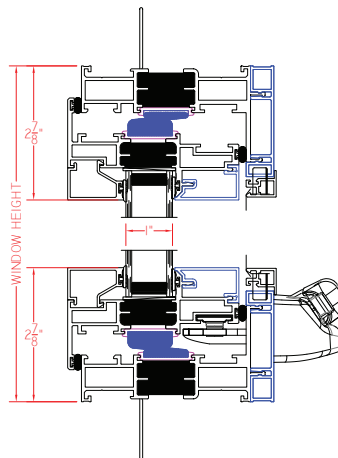

C605 Casement
shown with roto hardware, nail fin and traditional/historic beveled frame glazing

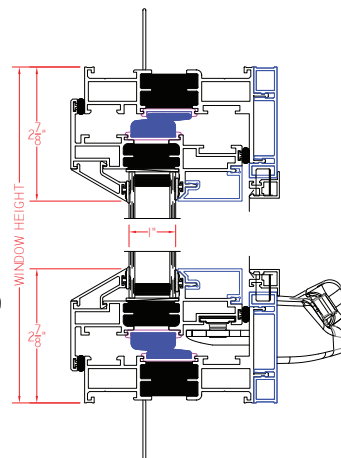

University of Maryland School of Pharmacy
Baltimore, MD
Contractor: EMJAY Engineering & Const. Co.
Architect: JMT Architecture
Comm. Window Dealer: Window Consultants, Inc.
LEED: Gold



Credit: JMT Architecture/jmtarchitecture.com

C600

COMMERCIAL ALUMINUM SERIES

Products

Project-Out

- Up to AW-PG100 Rating
- Patented OptiCore® technology
- Architectural grade aluminum
- With or without Integral nailing fin
- Up to 1½" I.G. w/warm-edge spacer
- Roto and Cam-Handle hardware
- Optional OS Operator hardware
- FlexScreen® system
- Blinds/Storm Panel option
- Standard and custom sizing
- Continuous frame combination capability
- Modern/Square exterior glazing profile (C600) or Traditional/Historic Bevel exterior glazing profile (C605)
- Impact version (C670/C675)

C600 Project-Out
shown with roto hardware, nail
fin and modern/squared
frame glazing

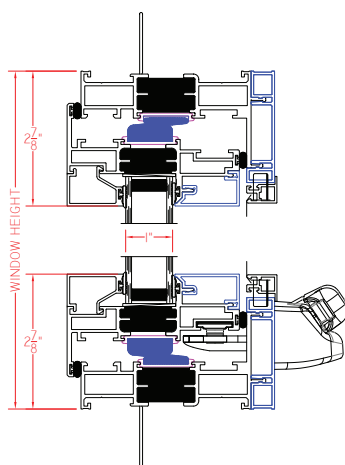

C605 Project-Out
shown with roto hardware,
nail fin and traditional/historic
beveled frame glazing

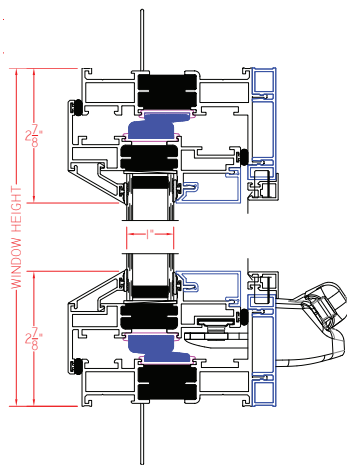

C600 Project-Out
shown with roto hardware, nail
fin, modern/squared frame
glazing, and blinds/storm panel

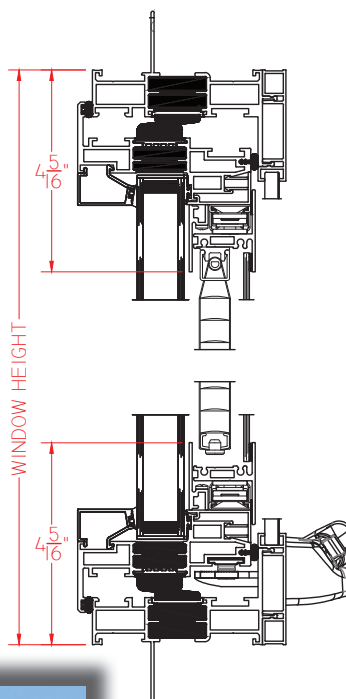

C605 Project-Out
shown with roto hardware, nail fin,
traditional/historic beveled frame
glazing and blinds/storm panel

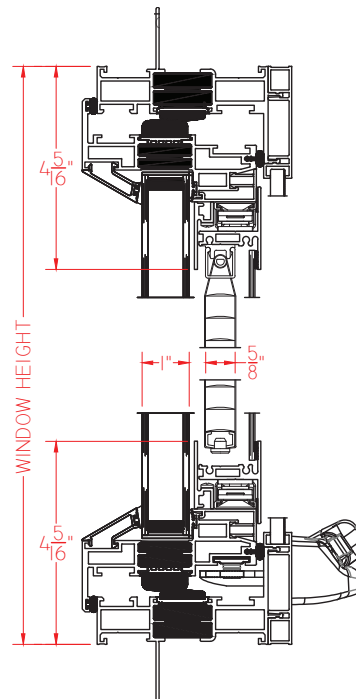

Alate Old Town
Alexandria, VA
Developer: BRG Belmont Bay LLC
Contractor: Bonaventure Construction LLC
Architect: J Price Architecture
Commercial Window Dealer: Revolution Bldg. Supply

Credit: ARHA.com



www.QuakerCommercialWindows.com

C600

COMMERCIAL ALUMINUM SERIES

Products

Fixed

- Up to AW-PG100 Rating
- Patented OptiCore® technology
- Architectural grade aluminum
- With or without Integral nailing fin
- Up to 1½" I.G. w/warm-edge spacer
- Wide or Narrow sightlines on fixed models
- Continuous frame combination capability
- Blinds/Storm Panel option
- Standard and custom sizing
- Modern/Square exterior glazing profile (C600) or Traditional/Historic Bevel exterior glazing profile (C605)
- Impact version (C670/C675)

C600 Fixed
shown with nail fin and
modern/squared
frame glazing

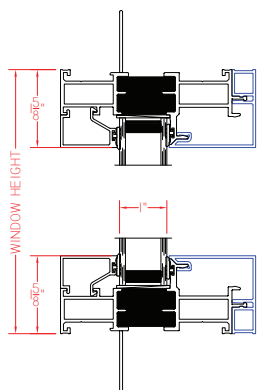

C605 Fixed
shown with nail fin and
traditional/historic
beveled frame glazing

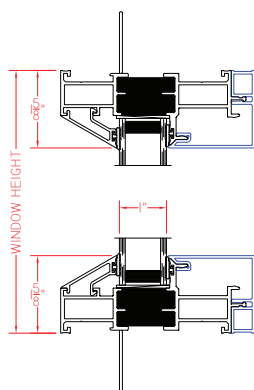

C600 Fixed
shown with nail fin, modern/
squared frame glazing, and
blinds/storm panel

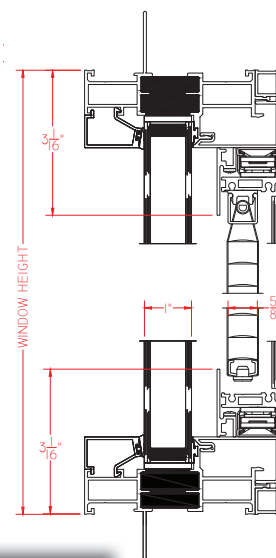

C605 Fixed
shown with nail fin, traditional/
historic beveled frame glazing
and blinds/storm panel

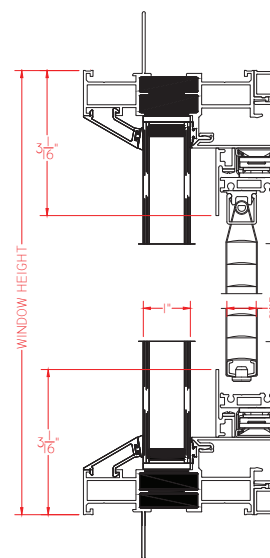

Terwilliger Place
Arlington, VA
Developer: Post West Nine Limited Partnership
Contractor: CBG Building Company
Architect: DCS Design
Comm. Window Dealer: Caffes-Steel

Credit: Costar.brightspotcdn.com

800-347-0438



C600

COMMERCIAL ALUMINUM SERIES

Colors

Quaker makes it easy to get your color right with more than 40 "Quick Pick" powder-coat paint colors. If that's not enough, Quaker offers full custom color capabilities, meaning you can grab any color in the spectrum for your project.

The Basics: Nearly 30 color tones that never go out of style.



Resembles: Powder coat, paint finishes made to resemble an anodized look.



- Resembles painted finishes have double the warranty (10 years vs. 5 years for anodized)
- Shorter lead times as Quaker paints all aluminum lineals in-house while anodized must be outsourced.
- Better pricing across the board vs. anodized
- Consistent painted finish for each rail as opposed to the industry-accepted ranges that come with the anodizing process.

Textured: Unique depth and feel to elevate your color choice.

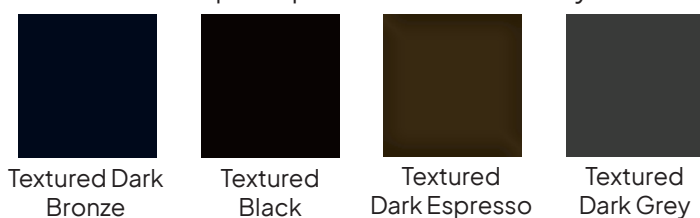

Custom Colors:

- Custom colors are a Quaker specialty.
- Our state-of-the-art, in-house painting facilities allow you to easily choose a custom color without incurring an exorbitant cost.
- From the purest white to the darkest black, any color is right at your fingertips.



C600

COMMERCIAL ALUMINUM SERIES

Finishes. Options. Warranties.

Paint Finishes:

- Standard: High-performance 2604 Powder Coat finish (an FGIA specification)
- Upgrade: Max-performance 2605 Powder Coat finish* (an FGIA specification) **2605 finish not available for all colors*

Heat Reflective: Keeps aluminum window and door exteriors cooler by repelling excessive solar heat.

- Available with these colors: Black, Dark Bronze, Textured Black, Textured Dark Bronze, & Textured Dark Espresso
- Proven technology adapted to work with windows
- Paint additive works much like Low-E works in glass
- Reduces the possibility of thermal heat transfer through windows and doors

Anodized: Available by request if commercial anodized finishes are a must for your project.

- Quaker offers only Class I anodized finishes, the highest grade available for exterior usage and vastly superior to Class II anodized
- Seven Anodized colors ranging from clear to black.

Paint & Finish Warranty:

- 10 year limited warranty on 2604 paint finish
- Up to 20 year limited warranty on 2605 paint finish
- 5 year limited warranty on Anodized finishes
- See complete warranty details at QuakerCommercialWindows.com

Two Tone Capability:

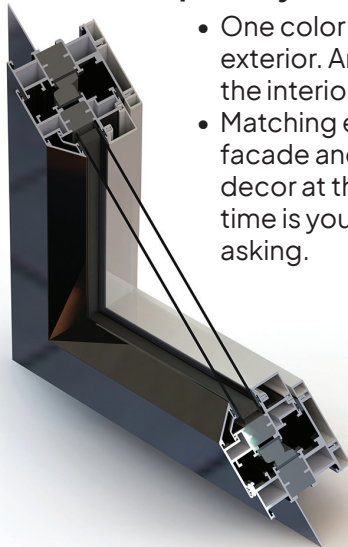

- One color on the exterior. Another on the interior.
- Matching exterior facade and indoor decor at the same time is yours for the asking.

Although every effort is made, the sample colors shown in this brochure may not perfectly reflect the actual paint color once it has been applied. For an exact color match, please contact Quaker.

Quaker Windows & Doors does not assume any responsibility for possible misrepresentations of our colors and reserves the right to add, remove or alter the color offerings and/or information shown here without notice.



Raymond E. Shaw Elementary School
Milbury, MA
Owner: Milbury Public Schools
Contractor: Fontaine Brothers
Architect: T2 Architecture
Glazer Contractor: Chandler Architectural Prods.
Credit: T2 Architecture

C600

COMMERCIAL ALUMINUM SERIES

Options

Glass & Grids

Pane thickness

- $\frac{3}{32}$ "
- $\frac{1}{8}$ "
- $\frac{5}{32}$ "
- $\frac{3}{16}$ "
- $\frac{1}{4}$ "
- $\frac{5}{16}$ "

I.G. thickness

- 1" (Double pane)
- 1 $\frac{3}{8}$ " (Triple pane)
- 1 $\frac{1}{2}$ " (Triple pane)

Glass Types

- Dual Silver Low-E
- Triple Silver Low-E
- Interior Pane Low-E
- Tempered Safety Glass
- Laminated
- Spandrel
- Neat+ Low Maintenance
- Obscure (for privacy)
- Tinted
- Bird Glass
- and many others

Some limitations may apply based upon several variables including, but not limited to, the window/door series chosen and requested/required specifications.



Simulated Divided Lites

- Numerous profiles and combinations available

This is a small sampling of the many SDL grid profiles Quaker has available.

Grids Between the Glass

- Flat or Contoured

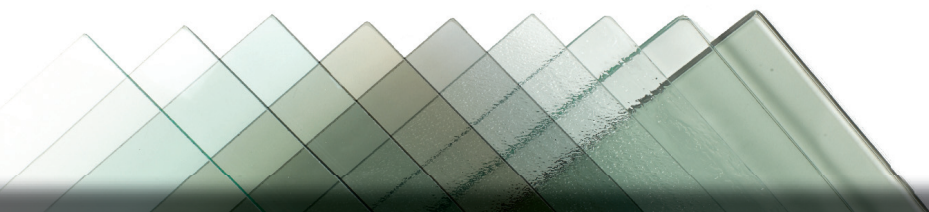
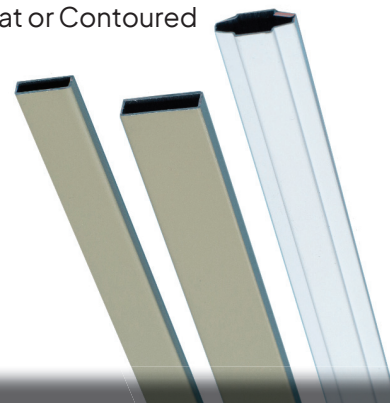

1550 Lincoln
Santa Monica, CA
Developer: WS Communities
Contractor: MAS Construction
Architect: KFA Architecture
Comm. Window Dealer: Hardy Window



Credit: showcase.com



www.QuakerCommercialWindows.com

C600

COMMERCIAL ALUMINUM SERIES

Options

Mulls

Whether you're stacking units or pairing them side-by-side -- or both -- trust C600 mull systems to hit the mark.

C600 mulls can be factory-applied* or field applied. Your choice.

With a multitude of mull choices, you can accommodate your design configs and meet structural DP specifications at the same time.

Mull choices#:

- Vertical mulls - up to 1" wide
- Horizontal mulls - up to 1" tall
- Post Mulls
- Mull Covers - up to 7" wide

**Limitations apply.*

#Mull choices may be subject to usage limitations

The Drake
Athens, GA
Owner: TWA Broad Street LLC
Contractor: Grahl Construction
Architect: Studio BNA Architects
Glazing Contractor: Maner Glass



Credit: drakeathens.com

Axiom East
Austin, TX
Owner: Harris Bay
Contractor: Trinity Constructors
Architect: Designtrait Architects
Glazing Contractor: Western Glass



Credit: [BailyOlivas / bailyolivas.com](http://BailyOlivas.com)

800-347-0438



C600

COMMERCIAL ALUMINUM SERIES

Options

Accessories

The Langley
Houston, TX
Owner: 1717 Bissonnet Prpco, LLC
Contractor: SLRTX Bissonnet Construction
Architect: EDI International
Glazing Contractor: Ranger Specialized Glass



Render Credit: The Langley / thelangleyhouston.com

Quaker can provide a multitude of accessories to make your C600 installation simple, efficient and successful.

- Panning
- Flashing
- Receptor
- Subsill
- Flush mount fin systems
- Anchor straps
- Interior and exterior trim

Other factory-applied* options include:

- Adjustable Limit Travel Devices
- WOCD (Window Operating Control Device)
- Friction Arm and more.

**Limitations may apply.*

Wood Interior

The C600 offers a deluxe wood interior option: The W600 Series.

- Same OptiCore® technology
- Same build
- Same AW ratings
- Same or better thermal performance

Available models:

- Casement
- Project-Out
- Fixed

Exterior Glazing Profile:

- Modern/Square (W600)
- Traditional/Historic Bevel (W605)

Features:

- Pine interior
- 4 1/8" or 6 1/8" jamb depths

W600

CLAD WOOD SERIES

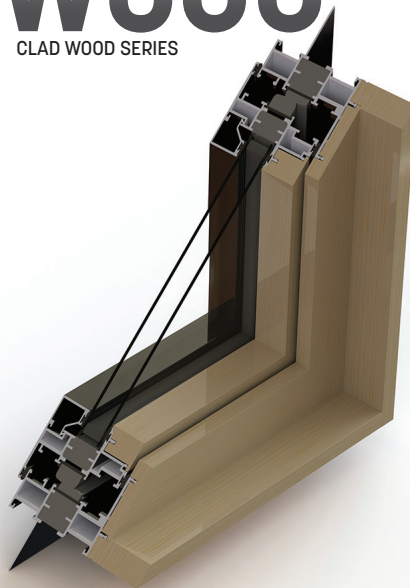

Interior



Natural (standard)

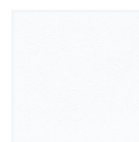

Primed



Pre-Finished
White



Pre-Finished
Black

Custom interior colors available.

Exterior

All color choices/options shown on pages 10-11 are available for the exterior.

C600

COMMERCIAL ALUMINUM SERIES

Solutions for Special Applications

Impact (C670/C675)

- Casement, Project-Out and Fixed window models
- All models meet ASTM 1886 (Large Missile Impact - Level D) testing requirements
- Various anchorage systems

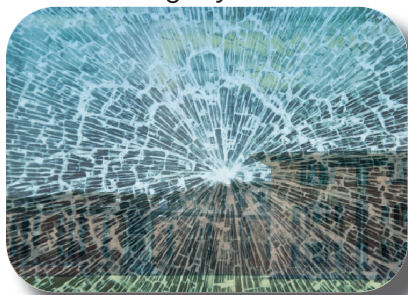

LEED®

- All C600 Series window models can assist with garnering LEED points for your commercial project
- LEED Building Design and Construction (LEED BD+C) works for both new construction and replacement commercial projects
- LEED is the world's preeminent green building organization
- Go to usgbc.org/leed for more information.

#-Quaker Window Products, Inc. does not make any guarantee of LEED-accreditation or Level Certification with the use of Quaker products.

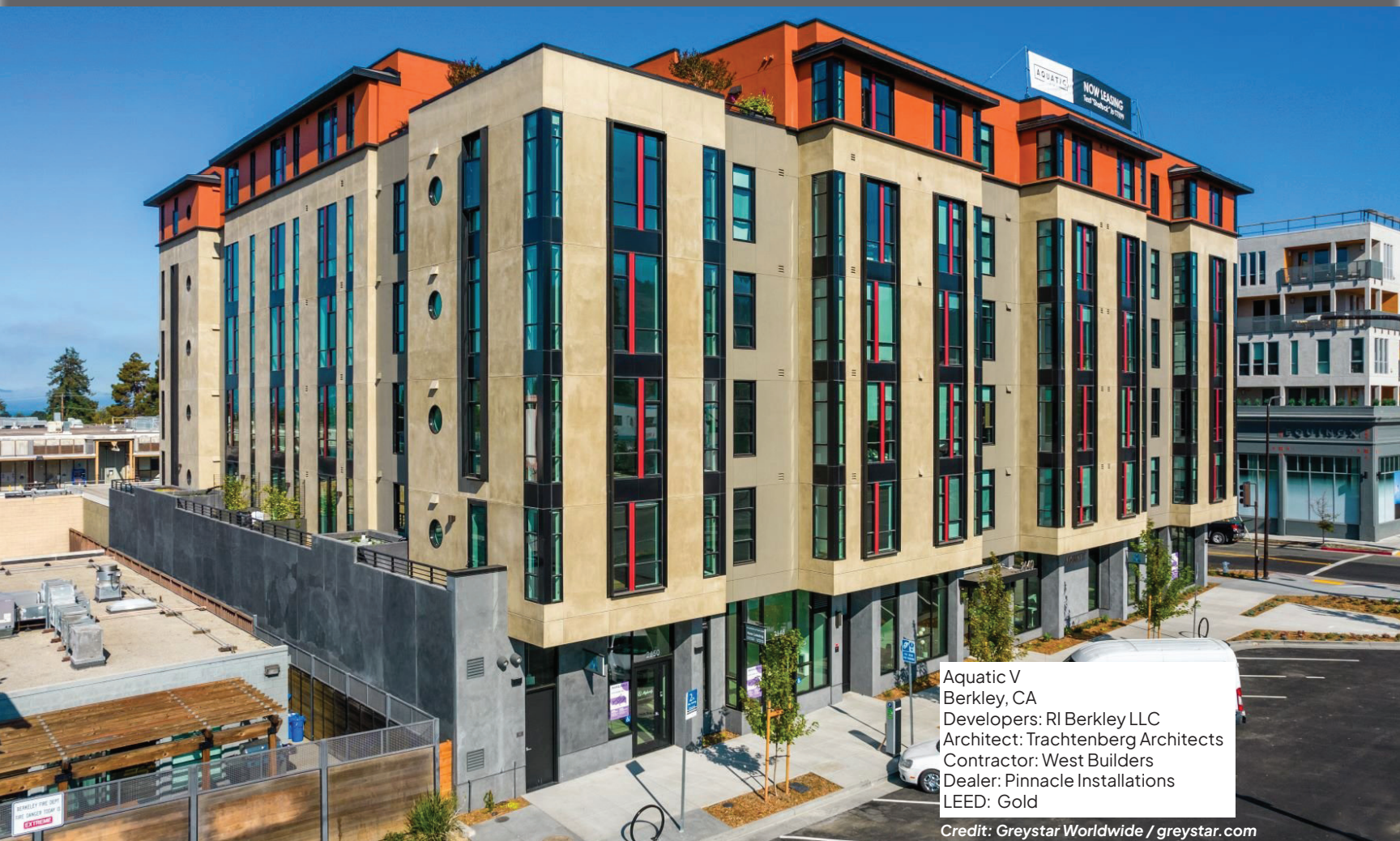

Aquatic V
Berkley, CA
Developers: RI Berkley LLC
Architect: Trachtenberg Architects
Contractor: West Builders
Dealer: Pinnacle Installations
LEED: Gold

Credit: Greystar Worldwide / greystar.com

800-347-0438



C600

COMMERCIAL ALUMINUM SERIES

Architectural Support Services

Quaker's Architectural Support Services Group brings together a range of experience to help navigate the complexities of modern architectural planning. The group assists by providing product-related insights that complement your design goals and professional responsibilities.

Using a proactive approach to risk mitigation, Quaker's Architectural Support Services Group can assist across a broad spectrum of architectural considerations:



- Project Specification Review



- Product Performance Data and Application Guidance



- Local and Architectural Sales Support



- Job-Specific Testing: In-House and In-The-Field



- Architectural Product Guidance



- Design, Drafting and Thermal Modeling

Plus, Quaker has a dedicated commercial team with more than 200 years of combined industry experience.



Discover more details regarding Quaker's unique Architectural Support Services, and connect with your local Sales & Architectural Consultant.



www.QuakerCommercialWindows.com

The Quaker Difference: More than meets the eye.

What distinguishes Quaker from all other window and door companies? The Quaker Difference. All Quaker products are comprised of tangible and intangible assets, working together to form the most sought-after windows in the market.

- It's a standard of craftsmanship and engineering excellence we build into every product.
- It's professional manufacturing specialists, some with more than 40 years of window experience, providing unparalleled attention to detail from start to finish.
- It's shying away from testing at only entry-level, gateway sizes. Instead, we test using exaggerated and even maximum sizing.
- It's multiple quality checks implemented throughout the manufacturing process to provide a paramount product.
- It's our state-of-the-art paint facilities. Unlike many manufacturers who must outsource, Quaker controls the quality and consistency of our finish in-house.
- It's employing thicker glass panes which will both lower the amount of stress cracks and raise your ability to control sound intrusion.
- It's our "can-do" attitude toward custom projects. Our option and accessory choices allow us to do what others often can't.
- It's doing more than just selling windows and doors. It's helping you find the right window and door solution for your project.

That's *The Quaker Difference*.



Congress Lofts at St. Elmo
Austin, TX
Developer: INTRACORP
Contractor: Summit Design+Build
Architect: PappaGeorge Haymes Partners
Glazing Contractor: Cantex Glass

Render Credit: INTRACORP

800-347-0438





C600

COMMERCIAL ALUMINUM SERIES

Find more information on Quaker windows and doors



 www.QuakerCommercialWindows.com

 1-800-347-0438

 commercial@quakerwindows.com



Made in America: All Quaker products are designed and manufactured in the United States at our state-of-the-art facilities in Eldon, MO (above) and Freeburg, MO.



January, 2026 - V6

Scan for Patent Information



ON THE COVER:

Smoky Hollow
Raleigh, NC
Developer: Kane Realty, Williams Realty & Bldg. Co.
Contractor: Clancy & Theys Construction Co.
Architect: JDAVIS Architects
Glazing Contractor: Brinn Glass, Inc.

Quaker Window Products reserves the right to change or discontinue any products or options within this brochure without notice.